

ELECTRICAL WIRING ROUTING

Position of Parts in Engine Compartment

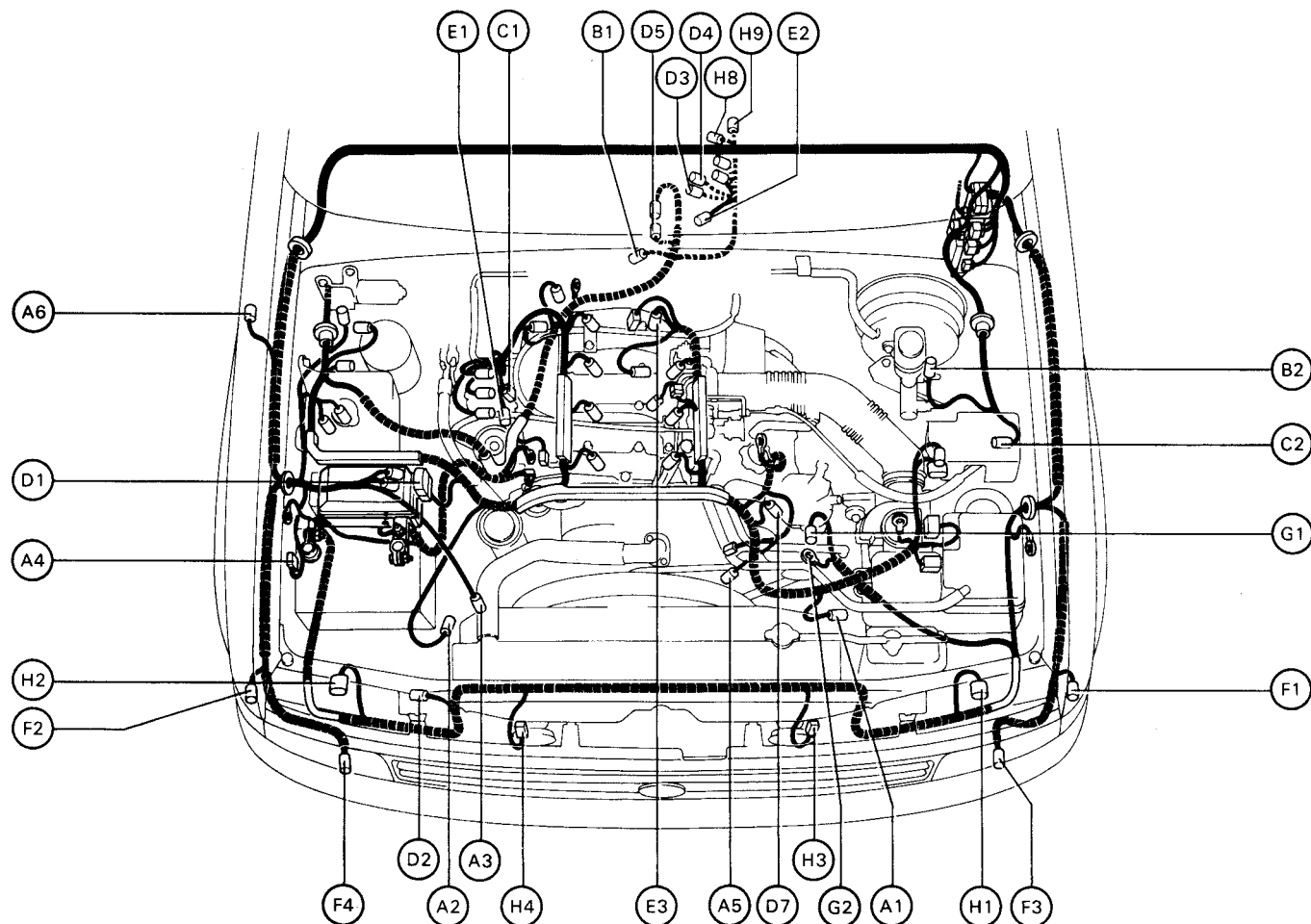

- A 1 A/C Idle-Up VSV
- A 2 A/C Magnetic Clutch
- A 3 ABS Actuator
- A 4 ABS Relay
- A 5 ADD Indicator SW (w/ ADD) or Short Pin (w/o ADD)
- A 6 Auto Antenna Motor

- B 1 Back-Up Light SW (M/T)
- B 2 Brake Fluid Level Warning SW

- C 1 Cold Start Injector
- C 2 Cruise Control Actuator

- D 1 Data Link Connector 1 (Check Connector)
- D 2 Daytime Running Light Resistor (Canada)
- D 3 Detection SW (Transfer L4 Position, A/T)
- D 4 Detection SW (Transfer Neutral Position, A/T)
- D 5 Detection SW (Transfer Position)
- D 7 Distributor

- E 1 EGR Gas Temp. Sensor (California) or Short Pin (Ex. California)
- E 2 Electronic Controlled Transmission Solenoid
- E 3 Engine Coolant Temp. Sensor (EFI Water Temp. Sensor)

- F 1 Front Clearance Light LH
- F 2 Front Clearance Light RH
- F 3 Front Turn Signal Light LH
- F 4 Front Turn Signal Light RH

- G 1 Generator (Alternator)
- G 2 Generator (Alternator)

- H 1 Headlight LH
- H 2 Headlight RH
- H 3 Horn LH
- H 4 Horn RH
- H 8 Heated Oxygen Sensor (Oxygen Sensor) Front
- H 9 Heated Oxygen Sensor (Oxygen Sensor) Rear (California 2WD)

Position of Parts in Engine Compartment

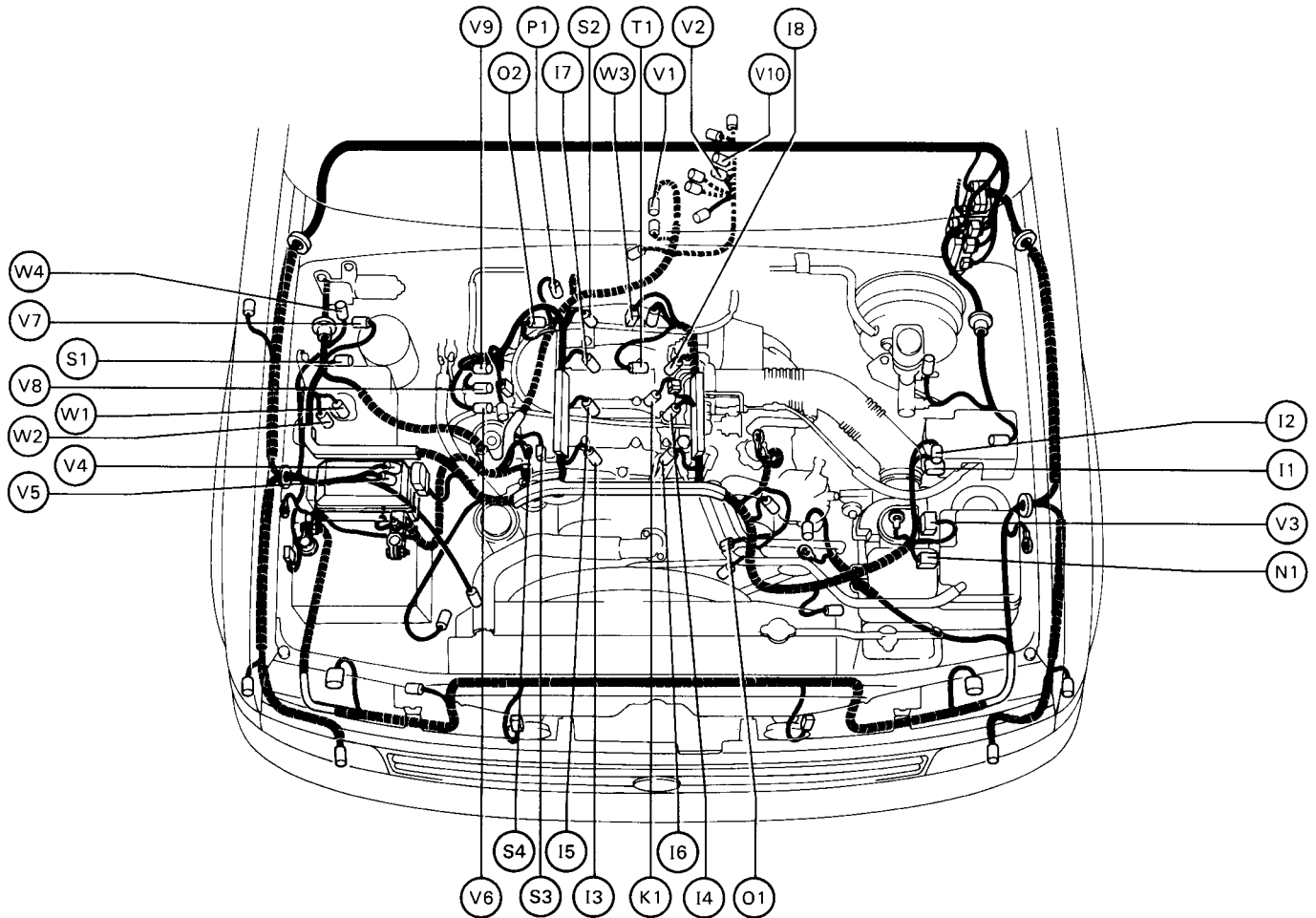

- I 1 Igniter
- I 2 Ignition Coil
- I 3 Injector No. 1
- I 4 Injector No. 2
- I 5 Injector No. 3
- I 6 Injector No. 4
- I 7 Injector No. 5
- I 8 Injector No. 6

- K 1 Knock Sensor

- N 1 Noise Filter

- O 1 Oil Pressure Sender
- O 2 Oil Temp. Sensor (A/T)

- P 1 Park/Neutral Position SW (Neutral Start SW),
Back-Up Light SW and A/T Indicator SW (A/T)

- S 1 Short Pin (Engine Control)
- S 2 Start Injector Time SW
- S 3 Starter
- S 4 Starter

- T 1 Throttle Position Sensor

- V 1 Vehicle Speed Sensor (Speed Sensor)
(Combination Meter, M/T and A/T 4WD)
- V 2 Vehicle Speed Sensor (Speed Sensor)
(Electrical Controlled Transmission)
- V 3 Volume Air Flow (Air Flow Meter)
- V 4 VSV (2WD, ADD)
- V 5 VSV (4WD, ADD)
- V 6 VSV (AS)
- V 7 VSV (AVAP)
- V 8 VSV (EGR)
- V 9 VSV (FPU)
- V 10 Vehicle Speed Sensor (Combination Meter, A/T 2WD)

- W 1 Washer Level SW
- W 2 Washer Motor
- W 3 Water Temp. Sender
- W 4 Wiper Motor

ELECTRICAL WIRING ROUTING

Position of Parts in Instrument Panel

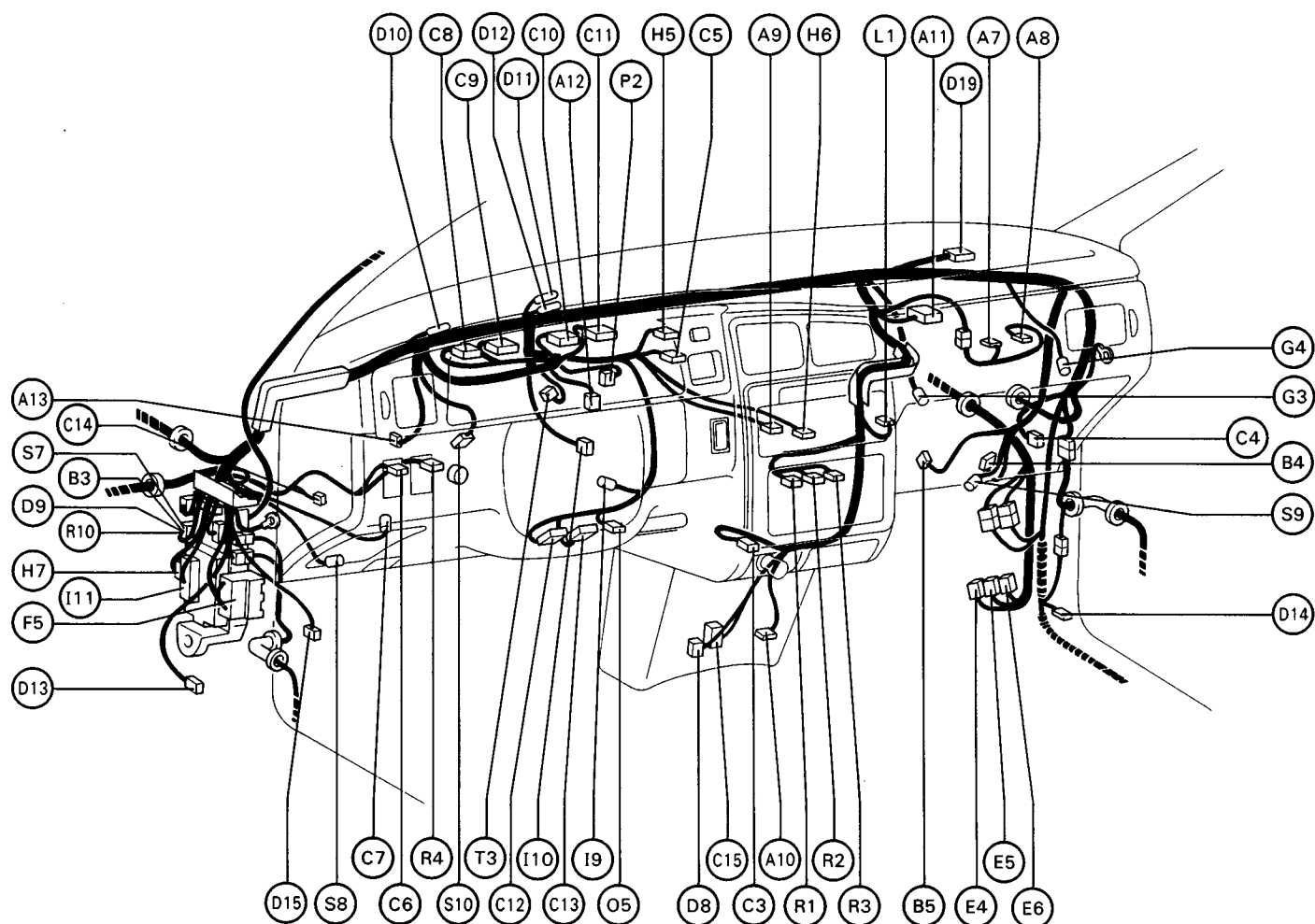

A 7 A/C Amplifier	D 8 Daytime Running Light Relay (Canada)	H 5 Hazard SW
A 8 A/C Dual Pressure SW and Thermistor	D 9 Daytime Running Light Relay No. 2 (Canada)	H 6 Heater Blower SW
A 9 A/C SW	D 10 Diode (Power Window)	H 7 Horn Relay
A 10 ABS Deceleration Sensor	D 11 Diode No. 1 (Daytime Running Light System, Canada)	I 9 Ignition Key Cylinder Light
A 11 ABS ECU	D 12 Diode No. 2 (Daytime Running Light System, Canada)	I 10 Ignition SW and Unlock Warning SW
A 12 ADD Control Relay	D 13 Door Courtesy SW LH	I 11 Integration Relay
A 13 Auto Antenna Control Relay	D 14 Door Courtesy SW RH	L 1 Light Reminder Relay
B 3 Back-Up Light Relay (USA A/T w/o Power Window)	D 15 Door Lock ECU	O 5 O/D Main SW
B 4 Blower Motor	D 19 Diode (A/T)	P 2 Parking Brake SW
B 5 Blower Resistor	E 4 Engine Control Module (Engine and Electronic Controlled Transmission ECU (A/T), Engine ECU (M/T))	R 1 Radio and Player
C 3 Cigarette Lighter	E 5 Engine Control Module (Engine and Electronic Controlled Transmission ECU (A/T), Engine ECU (M/T))	R 2 Radio and Player
C 4 Circuit Opening Relay	E 6 Engine Control Module (Engine and Electronic Controlled Transmission ECU (A/T), Engine ECU (M/T))	R 3 Radio and Player
C 5 Clock	F 5 Fuse Box (20A ECU-IG Fuse, 15A ECU-B and 7.5A DRL Fuse)	R 4 Rheostat
C 6 Clutch Start Cancel SW (M/T)	G 3 Glove Box Light	R 10 Relay Block
C 7 Clutch Start SW (M/T)	G 4 Glove Box Light SW	S 7 Starter Relay (USA w/o Power Window)
C 8 Combination Meter		S 8 Step Light LH
C 9 Combination Meter		S 9 Step Light RH
C 10 Combination Meter		S 10 Stop Light SW
C 11 Combination Meter		T 3 Turn Signal Flasher
C 12 Combination SW		
C 13 Combination SW		
C 14 Cruise Control Clutch SW (M/T)		
C 15 Cruise Control ECU		

Position of Parts in Body

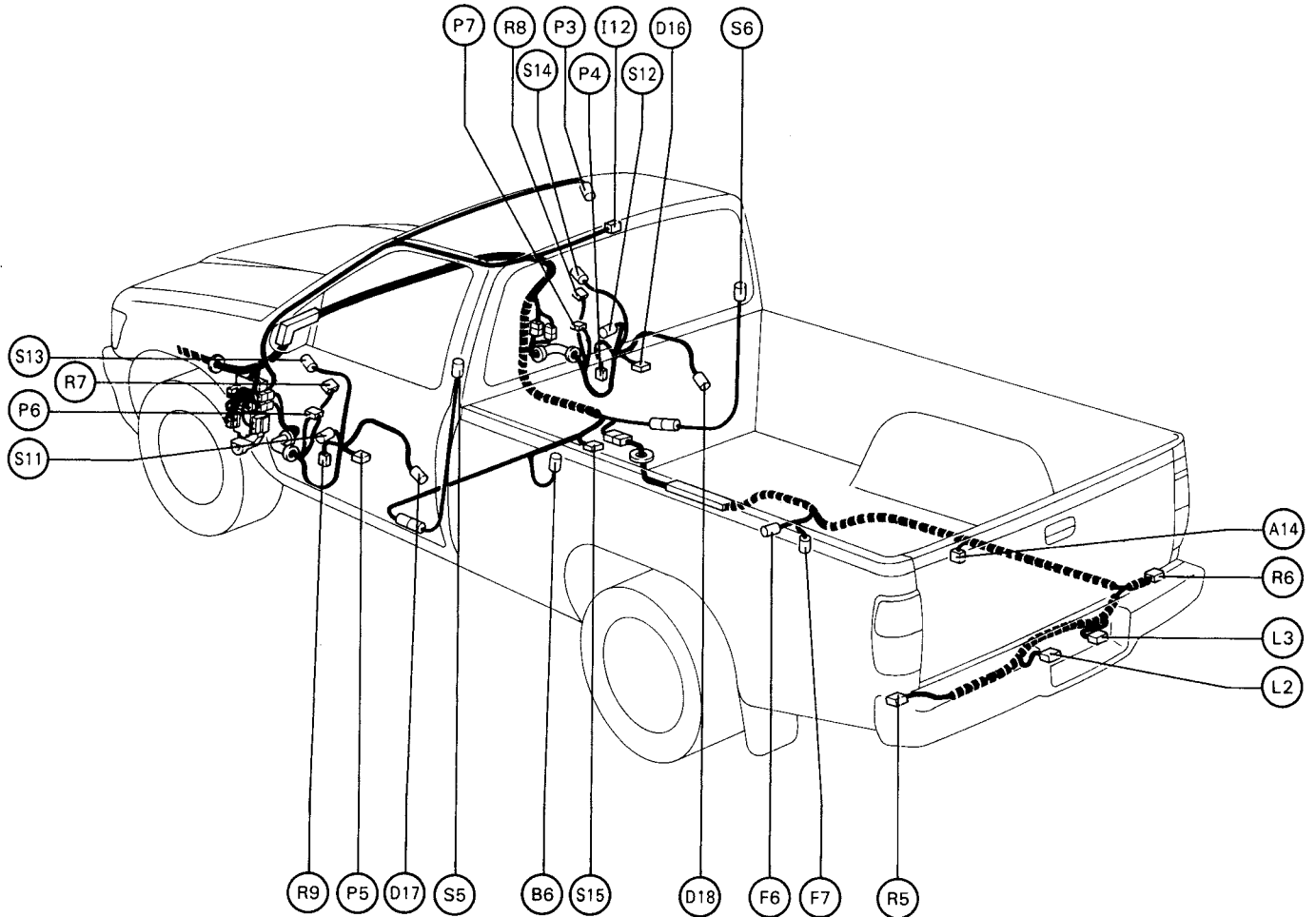

- | | |
|--|---|
| <p>A 14 ABS Speed Sensor</p> <p>B 6 Buckle SW</p> <p>D 16 Door Lock Control SW RH</p> <p>D 17 Door Lock Motor, Door Unlock Detection SW, Door Key Lock and Unlock SW LH</p> <p>D 18 Door Lock Motor, Door Unlock Detection SW, Door Key Lock and Unlock SW RH</p> <p>F 6 Fuel Pump</p> <p>F 7 Fuel Sender</p> <p>I 12 Interior Light</p> <p>L 2 License Plate Light LH</p> <p>L 3 License Plate Light RH</p> | <p>P 3 Personal Light</p> <p>P 4 Power Window Control SW RH</p> <p>P 5 Power Window Master SW and Door Lock Control SW</p> <p>P 6 Power Window Motor LH</p> <p>P 7 Power Window Motor RH</p> <p>R 5 Rear Combination Light LH</p> <p>R 6 Rear Combination Light RH</p> <p>R 7 Remote Control Mirror LH</p> <p>R 8 Remote Control Mirror RH</p> <p>R 9 Remote Control Mirror SW</p> <p>S 5 Speaker (Rear LH)</p> <p>S 6 Speaker (Rear RH)</p> <p>S 11 Speaker (Door LH)</p> <p>S 12 Speaker (Door RH)</p> <p>S 13 Speaker (Tweeter LH)</p> <p>S 14 Speaker (Tweeter RH)</p> <p>S 15 Speaker (Woofer)</p> |
|--|---|